

YADKIN COUNTY, NC YR 2018 REQUESTED BY DHAYES RUN 2/26/18 TIME 15:06:14

MACEMORE BOBBY S AND MACEMORE BOBBY S AND NBHD: 0813 123262 ROUTE#

3601 BEROOTH CIRCLE 3601 BEROOTH CIRCLE 495008992113

PPAFFTOWN NC 27040 PPAFFTOWN NC 27040 VALLEY & PARK ST

1103177 EXCD: 4950 08 99 2113

Appraiser: Appr Date: APPR: APPR DT: 11/12/1998 LAND VALUE 155,550

Bff Yr: USE CODE: MISC VALUE 0

Act Yr Bt: DISTRICT: 104 JONESVILLE-TOWN BLDG VALUE 0

HBth: NBHD: 0813 JONESVILLE CITY TOTAL VALUE 155,550

ASV SqFt Sales SqFt 2017 PRIOR YEAR 120,755

COMPONENT TYPE/CODE/DESC	PCT	UNITS	RATE	STR#	STR%	SIZE%	HGT%	PER%	CDS%	COST	%CML
--------------------------	-----	-------	------	------	------	-------	------	------	------	------	------

PROPERTY NOTES: BOBBY S. MACEMORE (2/3 INT) AND GLENN W. BAILEY (1/3 INT) BOOK PAGE DT DATE QS SALE

LAND ADJ SIZE/TOPO/SHAPE 1189 355 WD 8/16/2016 E

REPLACED SUDLE BAILEY WITH GLENN BAILEY PER 02-E/273; 587 478 UNK 2/01/2003 C

PERMIT NO TYPE DATE

BLDG CODE DESC	UNITS	EYB DT	PCT	ADD.DEPR PCT	QGCD	VALUE	EXCD	%COMP
						.00		
						.00		
						.00		
						.00		

LND #	ZONE	LAND TYPE/CODE	TOTAL ACRES:	LAND QTY	LAND ACRES	VALUE PER ACRE:	LAND RATE	DPH	DPT%	TOP%	LOC%	SIZE%	SHP%	OTH%	TOT ADJ	CURRE FMV
1		AC U	21.110	21.110	21.110	7,368.55			.00	.00	100.00	.00	.00	.00	1.00	15

123262 VALLEY & PARK ST

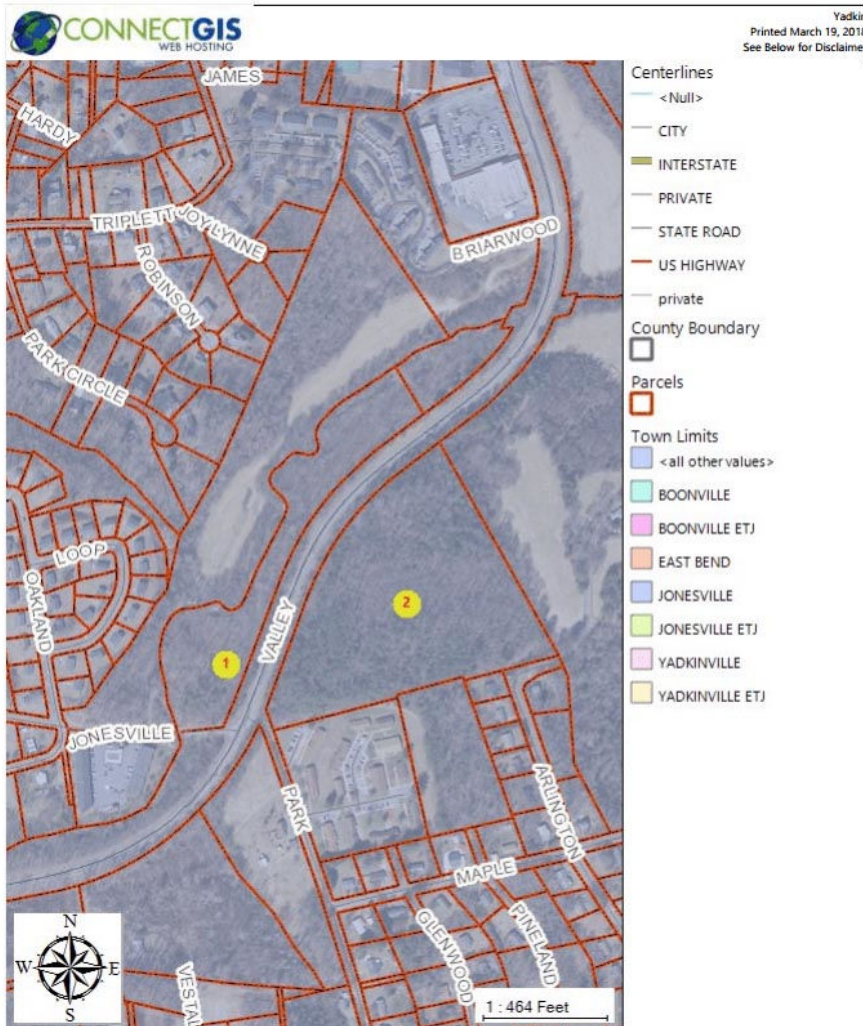

This information provided by the Yadkin County Government Website is a public service to the citizens of Yadkin County. The recipient may use this information with the understanding that Yadkin County makes no warranties, although every attempt will be made to ensure the information is accurate and timely. This web site is not intended to replace official sources and information should not be considered error-free or not be used as the exclusive basis for decision-making. The use of the information provided by this Web site is strictly voluntary and at the user's sole risk. Yadkin County assumes no responsibility or liability whatsoever associated with the use or misuse of this data.